

AF08072 2-bucket wringer trolley (large) Assembly Diagram

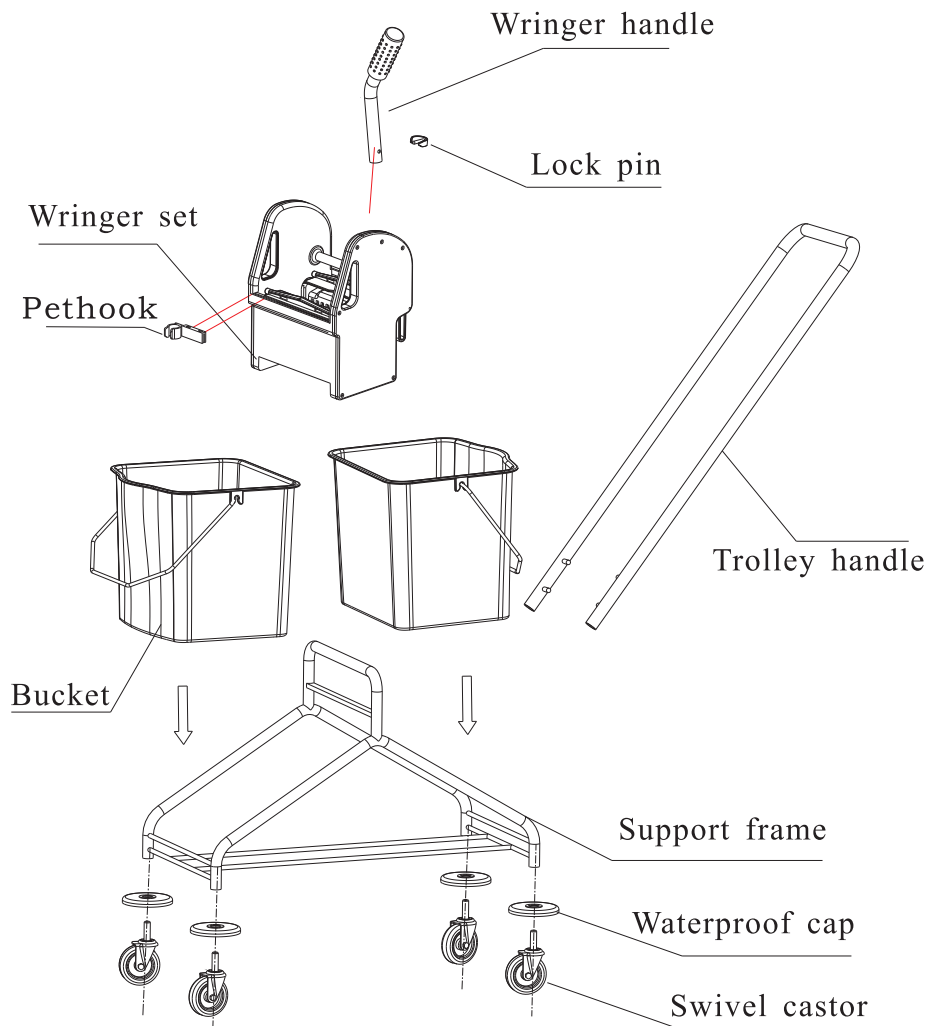

Assembly Instructions

Note: please read the following instructions carefully before installation.

- 1、 Turn over support frame, but make sure to bring no scratches for the plating surface.
- 2、 Place waterproof caps onto four feet of support frame. (as shown left)
- 3、 Insert castors into slots on bottom of frame and turn castors softly with wrench until most tightening.
- 4、 Please note there are higher and lower lock terminals at trolley handle bottom. Higher terminals should be matched with side holes in mid support of frame and lower ones should be under levers at one side of frame.
- 5、 Place two bucket on frame and please note that level surfaces of buckets should be inside forward. (as shown left)
- 6、 Fit wringer set onto mid support of farme stably.
- 7、 Insert wringer handle into aluminum tube seat and then insert lock pin completely. (as shown left)
- 8、 Upon no installation mistakes, it is the time to start cleaning.

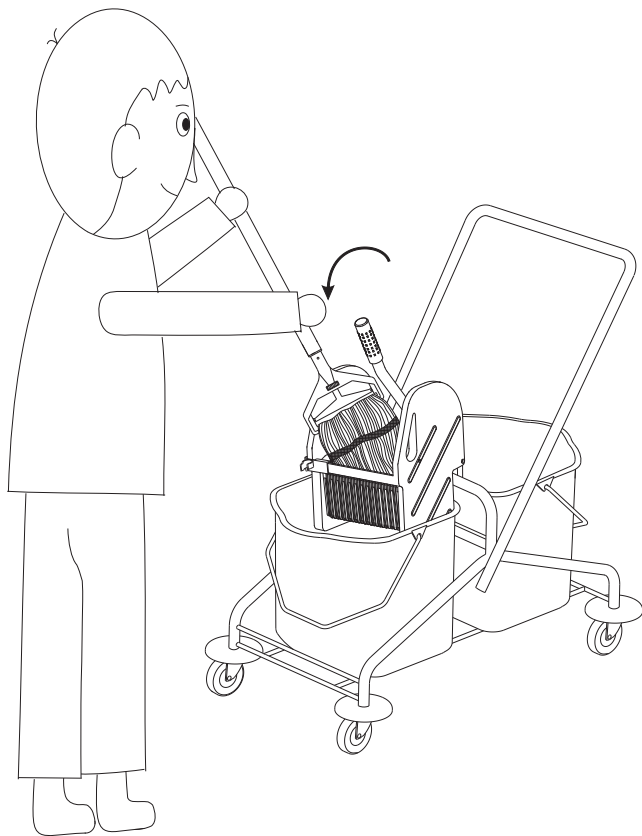

Safety regulations and instructions

- ① Check all parts for possible loose. Make sure all parts are fastened well before using.
- ② Check the lock pin and rubber sleeve of the handle. And fasten them if they are loose.
- ③ To avoid danger or harm, operator should stand right in front of the trolley. Put mop head in the wringer and press handle downward to squeeze water out of the mop.

NOTE: Appropriate strength should be taken to press the handle. It is ideal to squeegee out the 80% water of the mop. Do not overexert while pressing the handle.